

## SOCKET EXTENDER SMOOTH VERSION / MANCHON RALONGÉ LISSE VERLÄNGERUNG ALS ROHLING AUSGEFÜHRT

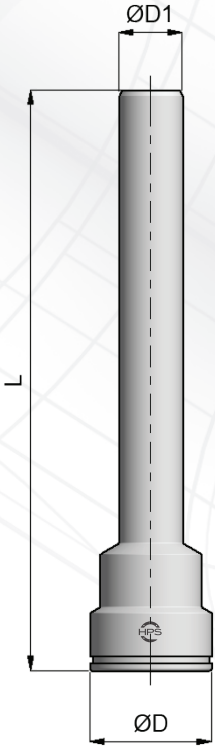

Thread (to be cut)	Dimensions (mm)			Part-number
	Ø D	Ø D1	L	Without ring
1/8	21	10.2	50	SE8T850
1/8	21	10.2	100	SE8T8100
1/8	21	10.2	150	SE8T8150
1/8	21	10.2	200	SE8T8200
1/8	21	10.2	250	SE8T8250
1/4	21	13.5	50	SE8T450
1/4	21	13.5	100	SE8T4100
1/4	21	13.5	150	SE8T4150
1/4	21	13.5	200	SE8T4200
1/4	21	13.5	250	SE8T4250
3/8	32	17.2	50	SE12T350
3/8	32	17.2	100	SE12T3100
3/8	32	17.2	150	SE12T3150
3/8	32	17.2	200	SE12T3200
3/8	32	17.2	250	SE12T3250
1/2	32	21.3	50	SE12T250
1/2	32	21.3	100	SE12T2100
1/2	32	21.3	150	SE12T2150
1/2	32	21.3	200	SE12T2200
1/2	32	21.3	250	SE12T2250



With blue ring add **B** to the part-number. With red ring add **R** to the part-number.

## SOCKET EXTENDER MALE THREAD / MANCHON RALONGÉ FILETÉ VERLÄNGERUNG MIT AUBENGEWINDE

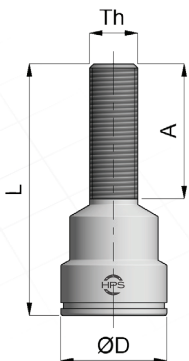

Th (BSP)	Dimensions (mm)			Part-number
	Ø D	L	A	Without ring
1/8	21	50	26	SE8R850
1/8	21	100	60	SE8R8100
1/8	21	150	60	SE8R8150
1/4	21	50	26	SE8R450
1/4	21	100	60	SE8R4100
1/4	21	150	60	SE8R4150
1/4	21	200	60	SE8R4200



With blue ring add **B** to the part-number. With red ring add **R** to the part-number.